

# COUNTY OF WARNER NO. 5 LAND USE DISTRICTS MAP A

## LAND USE DISTRICTS

Bylaw No: 930-17

October 24, 2017

Amended to and Including Bylaw 988-23

- EXTENSIVE AGRICULTURE (AG)
- GROUPED COUNTRY RESIDENTIAL (GCR)
- GROUPED RURAL INDUSTRIAL / COMMERCIAL (GRI/C)  
\*\*\*NO PARCELS ZONED AT THIS TIME
- URBAN FRINGE (UF)
- URBAN FRINGE AGRICULTURAL (UFA)
- URBAN FRINGE RESIDENTIAL (UFR)
- URBAN FRINGE INDUSTRIAL (UFI)
- HAMLET RESIDENTIAL (HR)
- HAMLET COMMERCIAL (HC)
- HAMLET INDUSTRIAL (HI)
- HAMLET PUBLIC / INSTITUTIONAL (HP/I)
- HAMLET TRANSITIONAL / AGRICULTURAL (HT/A)
- RURAL RECREATIONAL (RR)
- DIRECT CONTROL (DC)  
\*\*\*NO PARCELS ZONED AT THIS TIME
- LINEAR PARCEL DIRECT CONTROL\* (LPDC) - \*CPR R/W

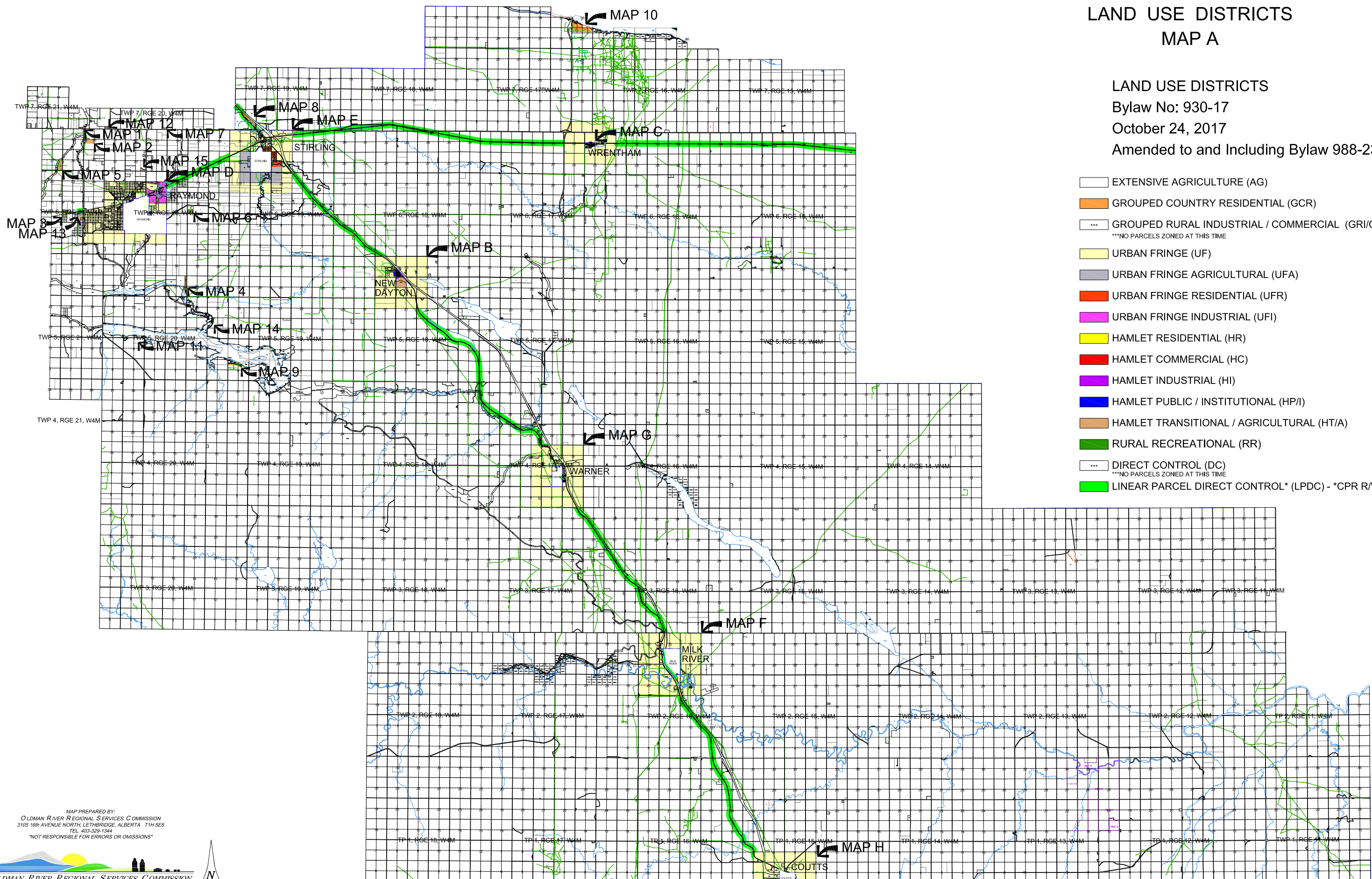

MAP PREPARED BY:  
OLDMAN RIVER REGIONAL SERVICES COMMISSION  
3105 16th AVENUE NORTH, LETHBRIDGE, ALBERTA T1H 5E8  
TEL. 403-329-1344  
"NOT RESPONSIBLE FOR ERRORS OR OMISSIONS"



# COUNTY OF WARNER NO. 5 LAND USE DISTRICTS MAP A-LPDC

LAND USE DISTRICTS  
Bylaw No: 930-17  
October 24, 2017

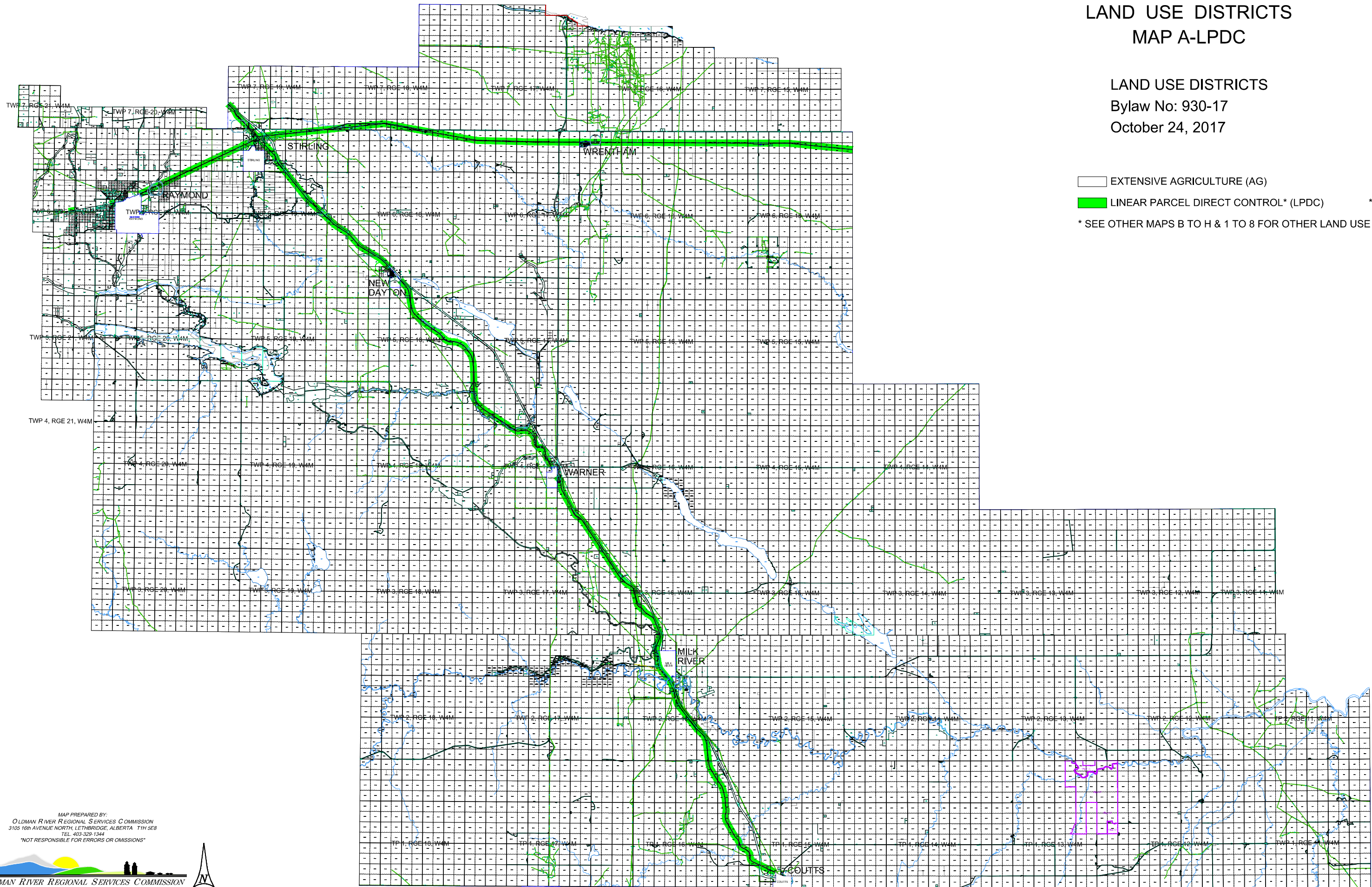

- EXTENSIVE AGRICULTURE (AG)
  - LINEAR PARCEL DIRECT CONTROL\* (LPDC) \*CPR R/W
- \* SEE OTHER MAPS B TO H & 1 TO 8 FOR OTHER LAND USE DISTRICTS

MAP PREPARED BY:  
OLDMAN RIVER REGIONAL SERVICES COMMISSION  
3105 16th AVENUE NORTH, LETHBRIDGE, ALBERTA T1H 5E8  
TEL 403-329-1344  
\*NOT RESPONSIBLE FOR ERRORS OR OMISSIONS\*



COUNTY OF WARNER NO. 5  
 LAND USE DISTRICTS  
 MAP B

DESIGNATED HAMLET OF  
 NEW DAYTON - FRINGE

LAND USE DISTRICTS  
 Bylaw No: 930-17  
 October 24, 2017



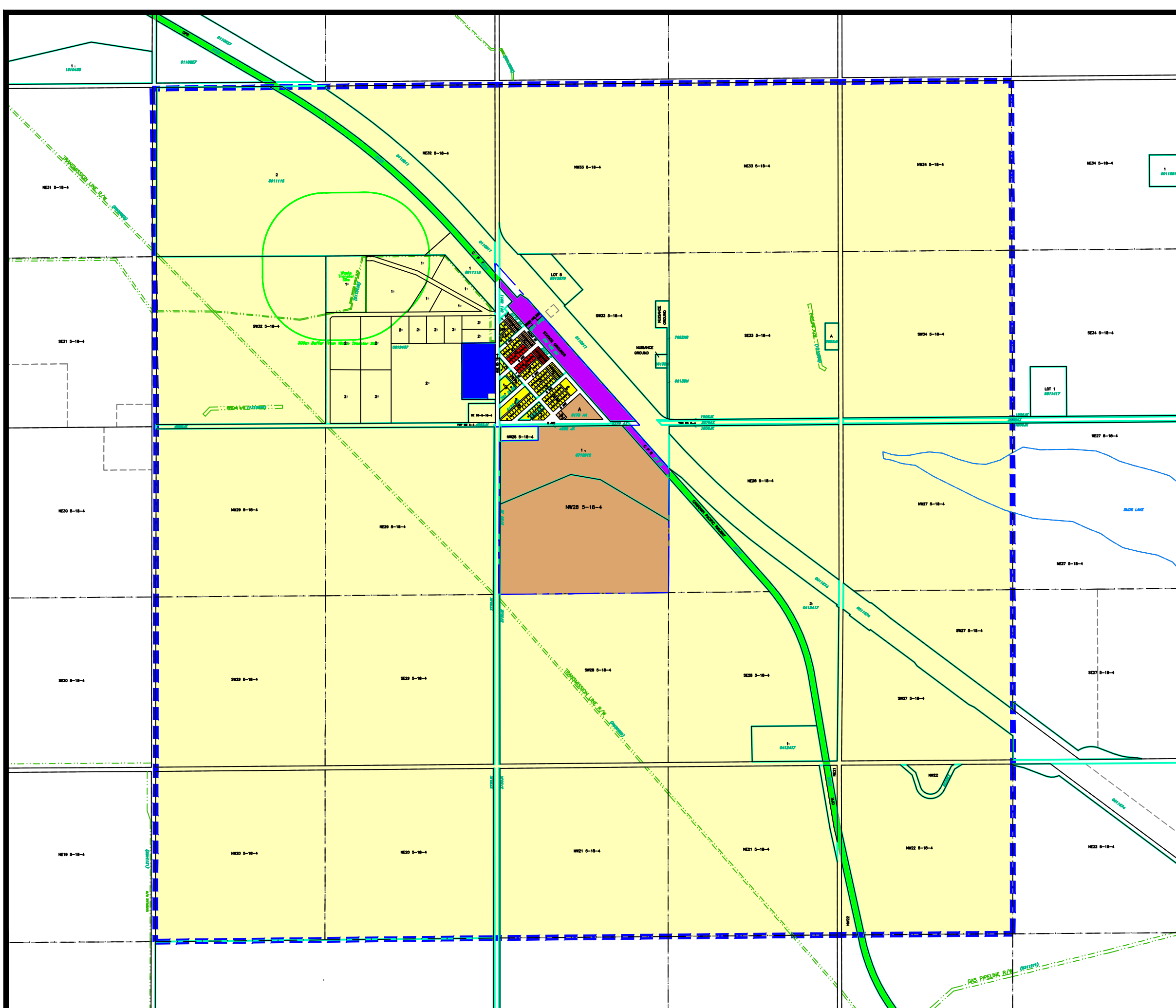





- EXTENSIVE AGRICULTURE (AG)
- URBAN FRINGE (UF)
- HAMLET COMMERCIAL (HC)
- HAMLET INDUSTRIAL (HI)
- HAMLET PUBLIC/INSTITUTIONAL (HP/I)
- HAMLET RESIDENTIAL (HR)
- HAMLET TRANSITIONAL/AGRICULTURAL (HT/A)
- LINEAR PARCEL DIRECT CONTROL (LPDC)
- HAMLET BOUNDARY

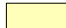

COUNTY OF WARNER NO. 5  
 LAND USE DISTRICTS  
 MAP B

DESIGNATED HAMLET OF  
 NEW DAYTON

LAND USE DISTRICTS  
 Bylaw No: 930-17  
 October 24, 2017

-  EXTENSIVE AGRICULTURE (AG)
-  URBAN FRINGE (UF)
-  HAMLET COMMERCIAL (HC)
-  HAMLET INDUSTRIAL (HI)
-  HAMLET PUBLIC/INSTITUTIONAL (HP/I)
-  HAMLET RESIDENTIAL (HR)
-  HAMLET TRANSITIONAL/AGRICULTURAL (HT/A)
-  LINEAR PARCEL DIRECT CONTROL (LPDC)
-  HAMLET BOUNDARY

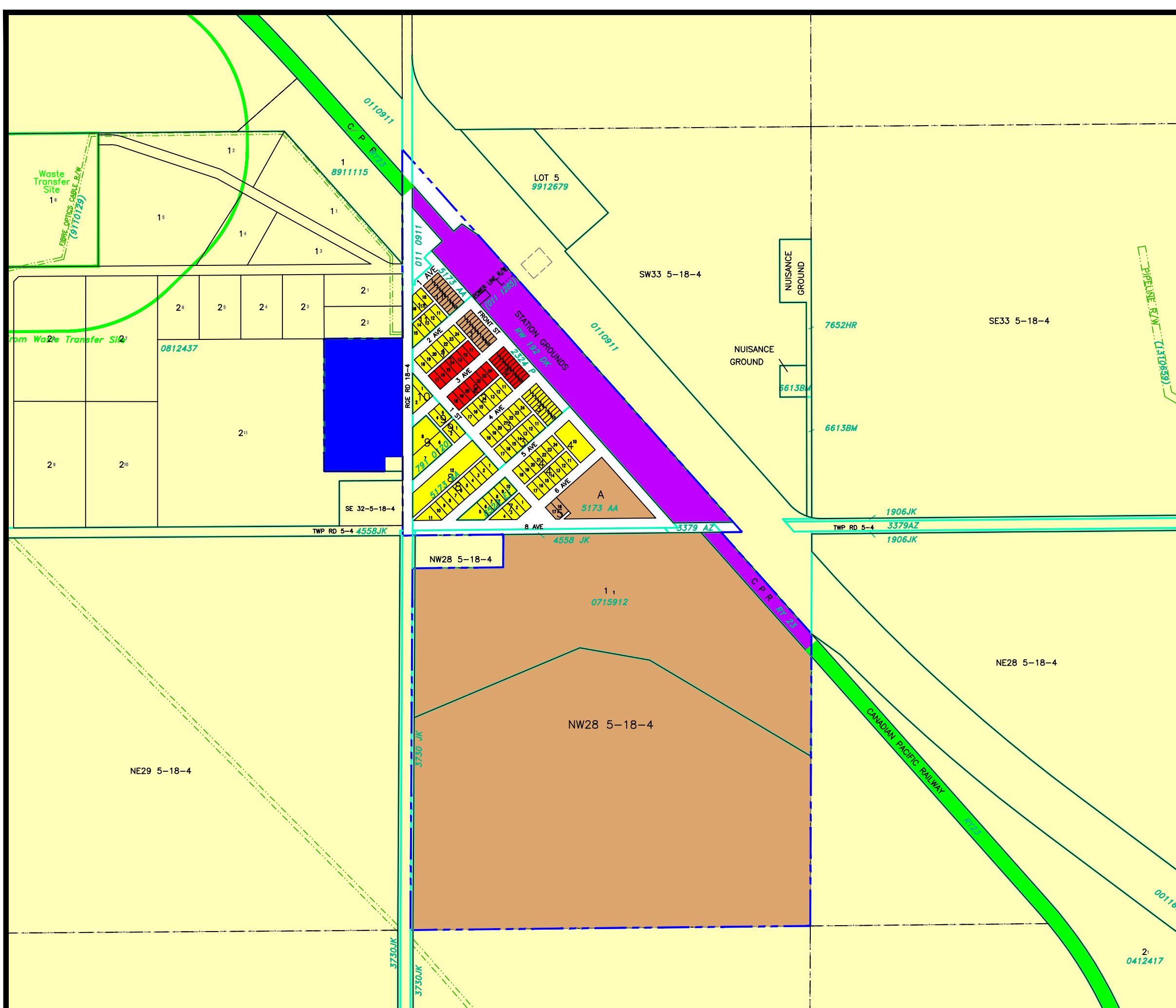









MAP PREPARED BY:  
 OLDMAN RIVER REGIONAL SERVICES COMMISSION  
 3105 16th AVENUE NORTH, LETHBRIDGE, ALBERTA T1H 5E8  
 TEL. 403-328-1344  
 "NOT RESPONSIBLE FOR ERRORS OR OMISSIONS"



COUNTY OF WARNER NO. 5  
 LAND USE DISTRICTS  
 MAP C

DESIGNATED HAMLET OF  
 WRENTHAM - FRINGE

LAND USE DISTRICTS  
 Bylaw No: 930-17  
 October 24, 2017  
 Amending Bylaw 980-22

-  EXTENSIVE AGRICULTURE (AG)
-  URBAN FRINGE (UF)
-  HAMLET COMMERCIAL (HC)
-  HAMLET INDUSTRIAL (HI)
-  HAMLET PUBLIC/INSTITUTIONAL (HP/I)
-  HAMLET RESIDENTIAL (HR)
-  HAMLET TRANSITIONAL/AGRICULTURAL (HT/A)
-  LINEAR PARCEL DIRECT CONTROL (LPDC)
-  HAMLET BOUNDARY

MAP PREPARED BY:  
 OLDMAN RIVER REGIONAL SERVICES COMMISSION  
 3105 16th AVENUE NORTH, LETSBIDGE, ALBERTA T1H 5E8  
 TEL. 403-329-1344  
 \*NOT RESPONSIBLE FOR ERRORS OR OMISSIONS\*

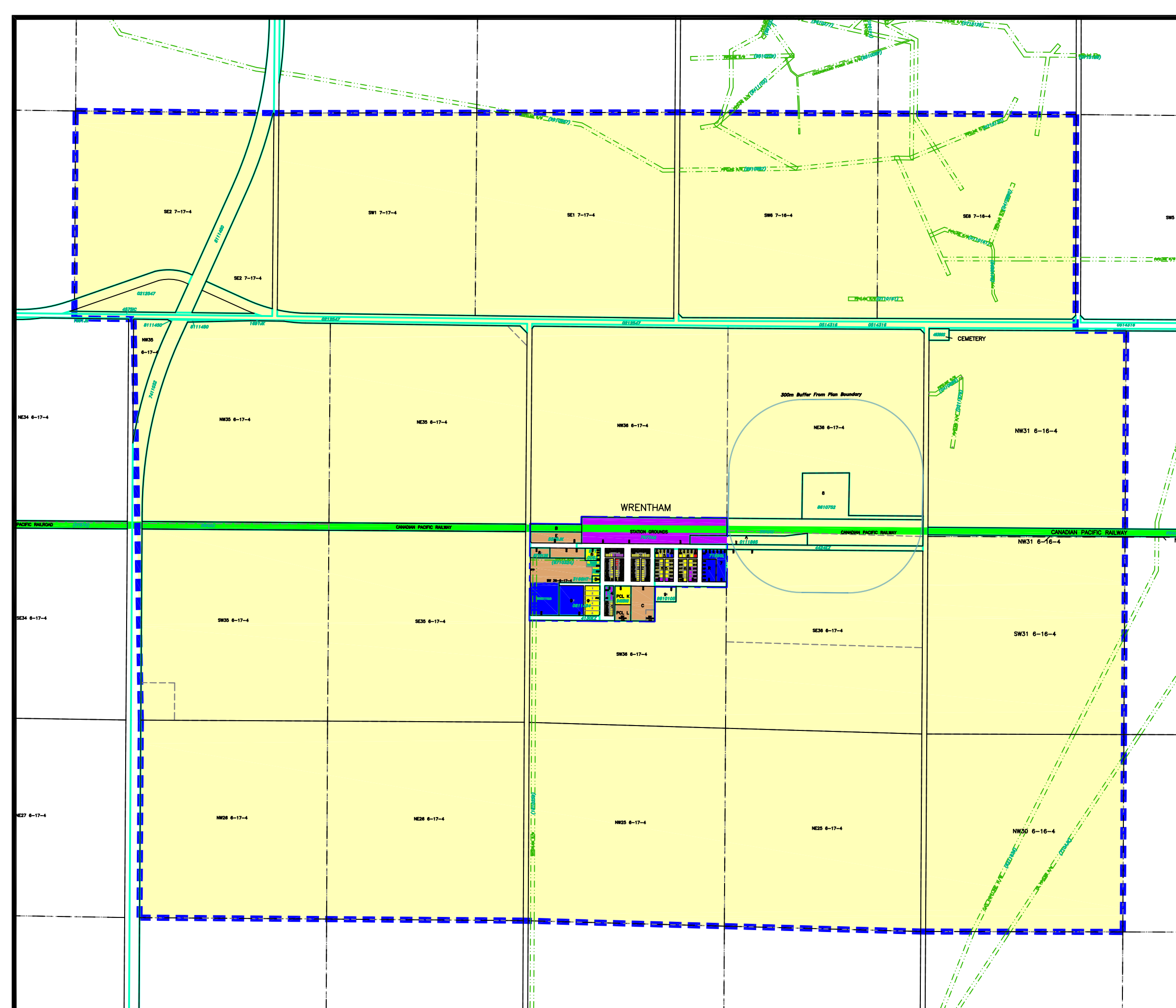

COUNTY OF WARNER NO. 5  
 LAND USE DISTRICTS  
 MAP C

DESIGNATED HAMLET OF  
 WRENTHAM

WRENTHAM

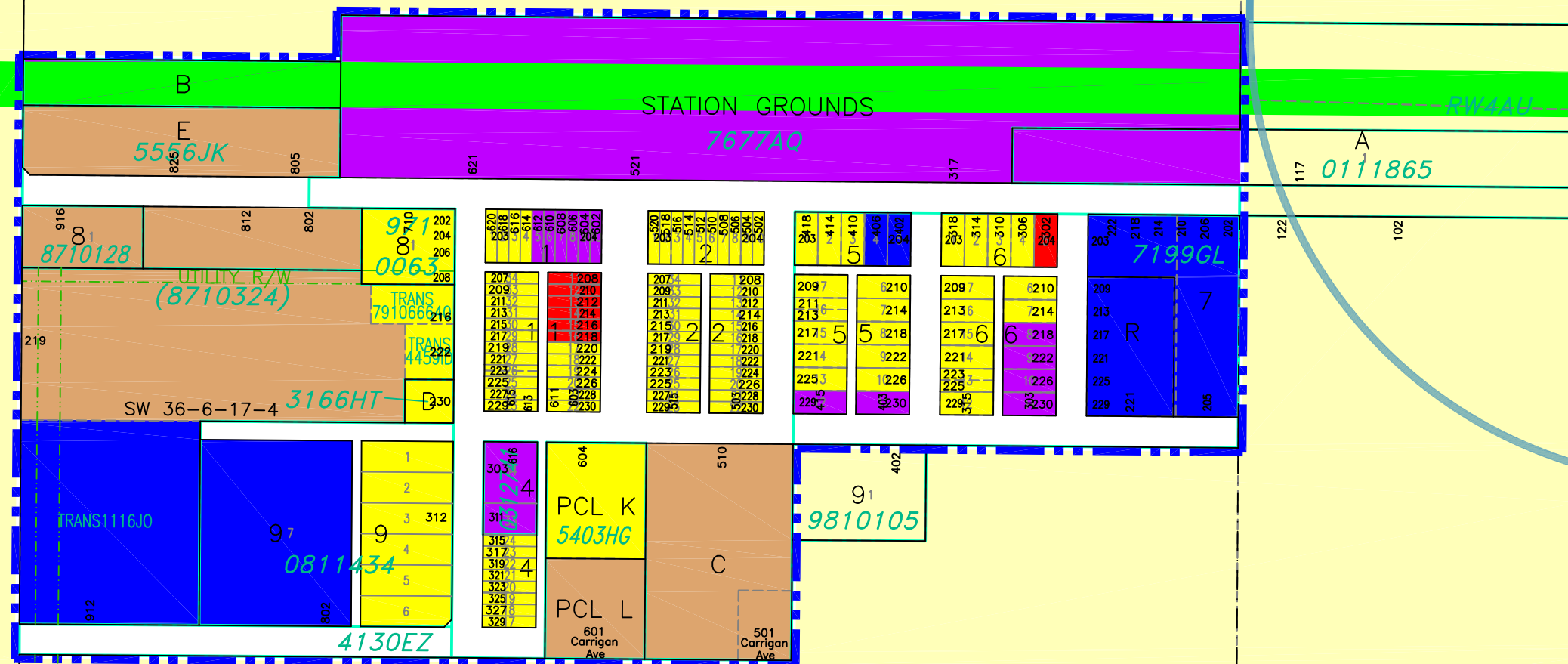

SW36 6-17-4

LAND USE DISTRICTS  
 Bylaw No: 930-17  
 October 24, 2017  
 Amending Bylaw 980-22

- EXTENSIVE AGRICULTURE (AG)
- URBAN FRINGE (UF)
- HAMLET COMMERCIAL (HC)
- HAMLET INDUSTRIAL (HI)
- HAMLET PUBLIC/INSTITUTIONAL (HP/I)
- HAMLET RESIDENTIAL (HR)
- HAMLET TRANSITIONAL/AGRICULTURAL (HT/A)
- LINEAR PARCEL DIRECT CONTROL (LPDC)
- HAMLET BOUNDARY

MAP PREPARED BY:  
 OLDMAN RIVER REGIONAL SERVICES COMMISSION  
 3105 16th AVENUE NORTH, LETHBRIDGE, ALBERTA T1H 5E8  
 TEL. 403-329-1344  
 \*NOT RESPONSIBLE FOR ERRORS OR OMISSIONS\*









COUNTY OF WARNER NO. 5  
LAND USE DISTRICTS  
MAP D

TOWN OF RAYMOND  
FRINGE

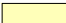
RAYMOND

LAND USE DISTRICTS  
Bylaw No: 930-17  
October 24, 2017

-  EXTENSIVE AGRICULTURE (AG)
-  GROUPED COUNTRY RESIDENTIAL (GCR)
-  URBAN FRINGE (UF)
-  URBAN FRINGE INDUSTRIAL (UFI)
-  LINEAR PARCEL DIRECT CONTROL (LPDC)
-  URBAN FRINGE BOUNDARY

COUNTY OF WARNER NO. 5  
LAND USE DISTRICTS  
MAP E

VILLAGE OF STIRLING  
FRINGE

STIRLING

LAND USE DISTRICTS  
Bylaw No: 930-17  
October 24, 2017

- EXTENSIVE AGRICULTURE (AG)
- URBAN FRINGE (UF)
- URBAN FRINGE AGRICULTURAL (UFA)
- URBAN FRINGE RESIDENTIAL (UFR)
- LINEAR PARCEL DIRECT CONTROL (LPDC)
- URBAN FRINGE BOUNDARY

MAP PREPARED BY:  
OLDMAN RIVER REGIONAL SERVICES COMMISSION  
3105 16th AVENUE NORTH, LETHBRIDGE, ALBERTA T1H 5E8  
TEL: 403-329-1344  
\*NOT RESPONSIBLE FOR ERRORS OR OMISSIONS\*







COUNTY OF WARNER NO. 5  
 LAND USE DISTRICTS  
 MAP F

TOWN OF MILK RIVER  
 FRINGE

MILK RIVER

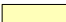
LAND USE DISTRICTS  
 Bylaw No: 930-17  
 October 24, 2017

-  EXTENSIVE AGRICULTURE (AG)
-  URBAN FRINGE (UF)
-  LINEAR PARCEL DIRECT CONTROL (LPDC)
-  URBAN FRINGE BOUNDARY

MAP PREPARED BY:  
 OLDMAN RIVER REGIONAL SERVICES COMMISSION  
 3105 16th AVENUE NORTH, LETHBRIDGE, ALBERTA T1H 5G8  
 TEL: 403-329-1344  
 \*NOT RESPONSIBLE FOR ERRORS OR OMISSIONS\*





November 08, 2017 N:\Warner-County\Warner-County LUD & Land Use Reorganization\Warner County LUD 930-17 October 24 2017 (Maps)\02

COUNTY OF WARNER NO. 5  
LAND USE DISTRICTS  
MAP G

VILLAGE OF WARNER  
FRINGE

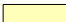
LAND USE DISTRICTS  
Bylaw No: 930-17  
October 24, 2017

-  EXTENSIVE AGRICULTURE (AG)
-  URBAN FRINGE (UF)
-  LINEAR PARCEL DIRECT CONTROL (LPDC)
-  URBAN FRINGE BOUNDARY

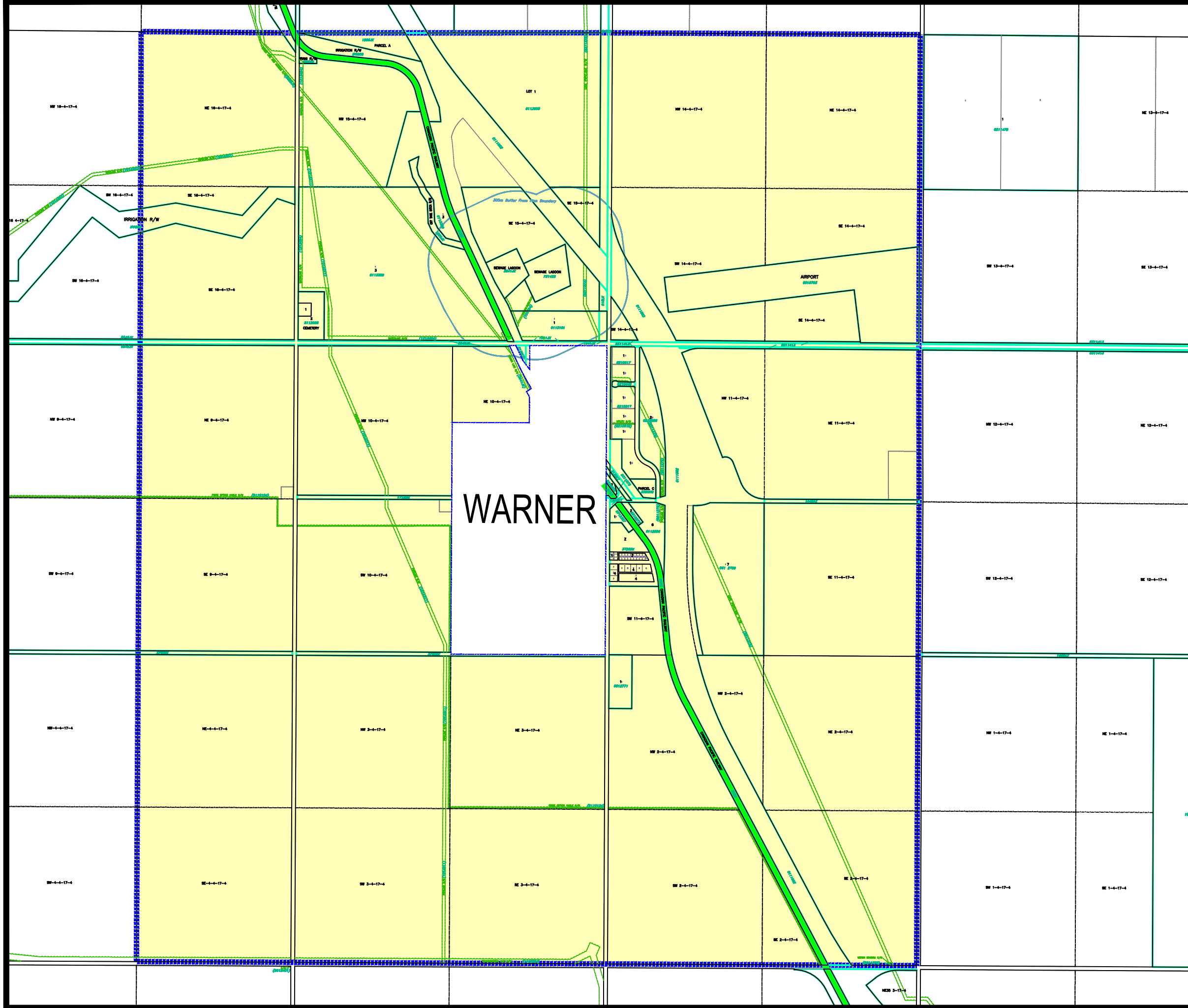



MAP PREPARED BY:  
OLDMAN RIVER REGIONAL SERVICES COMMISSION  
3105 16th AVENUE NORTH, LETHBRIDGE, ALBERTA T1H 5E8  
TEL: 403-329-1344  
\*NOT RESPONSIBLE FOR ERRORS OR OMISSIONS\*



COUNTY OF WARNER NO. 5  
 LAND USE DISTRICTS  
 MAP H

VILLAGE OF COUTTS  
 FRINGE

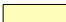
LAND USE DISTRICTS  
 Bylaw No: 930-17  
 October 24, 2017

-  EXTENSIVE AGRICULTURE (AG)
-  URBAN FRINGE (UF)
-  LINEAR PARCEL DIRECT CONTROL (LPDC)
-  URBAN FRINGE BOUNDARY

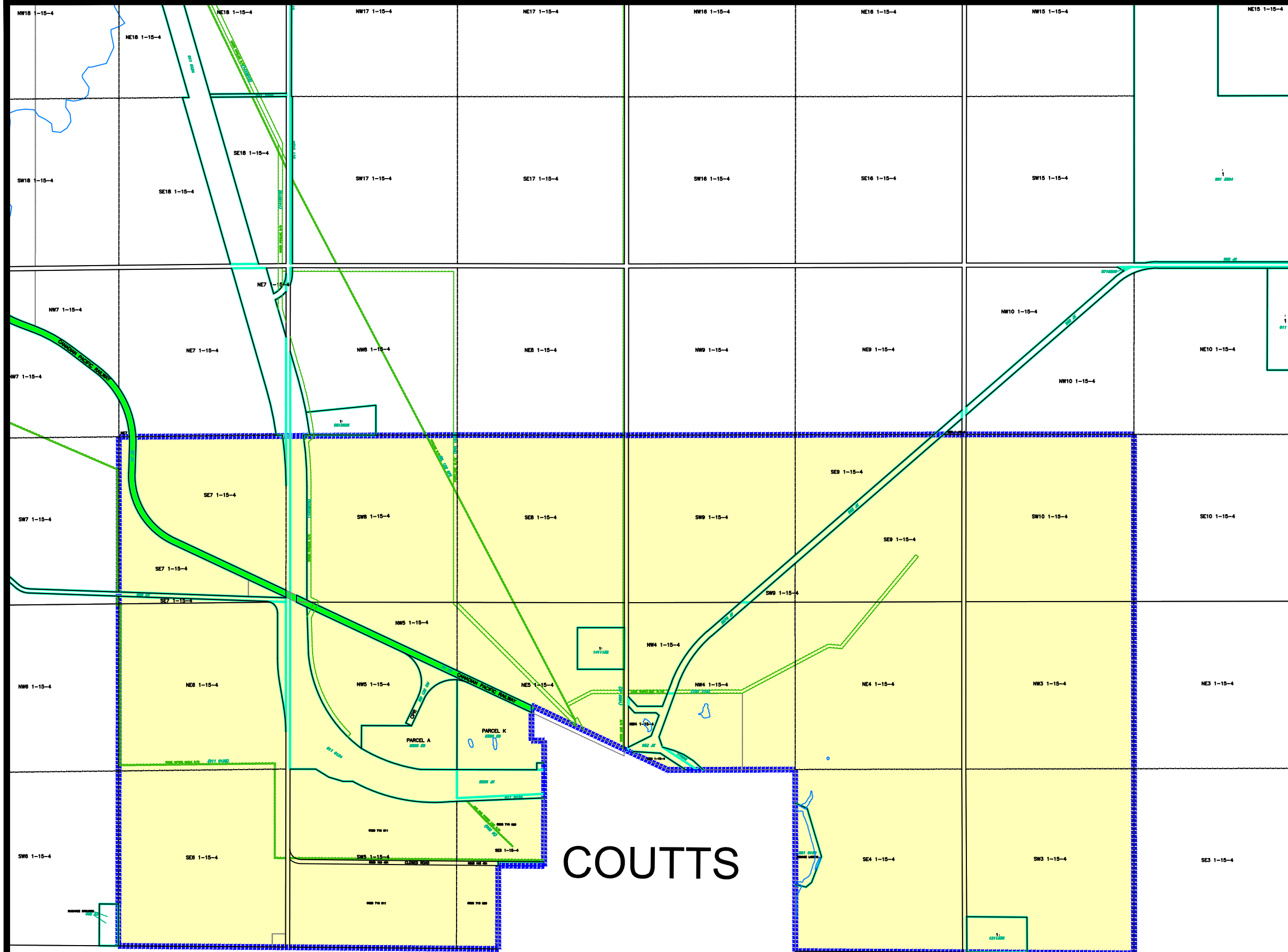

MAP PREPARED BY:  
 OLDMAN RIVER REGIONAL SERVICES COMMISSION  
 3105 16th AVENUE NORTH, LETHBRIDGE, ALBERTA T1H 5E9  
 TEL: 403-329-1344  
 \*NOT RESPONSIBLE FOR ERRORS OR OMISSIONS\*





November 08, 2017 N:\Warner-County\Warner-County LUO & Land Use Reorganization\Warner County LUO 930-17 October 24 2017 (Maps)\00

COUNTY OF WARNER NO. 5  
LAND USE DISTRICTS  
MAP 1

Lot 2, Block 1, Plan 0513604, &  
Lots 3 & 4, Block 1, Plan 0614487 In  
SE 1/4 SEC 1, TWP 7, RGE 21, W4M

LAND USE DISTRICTS  
Bylaw No: 930-17  
October 24, 2017

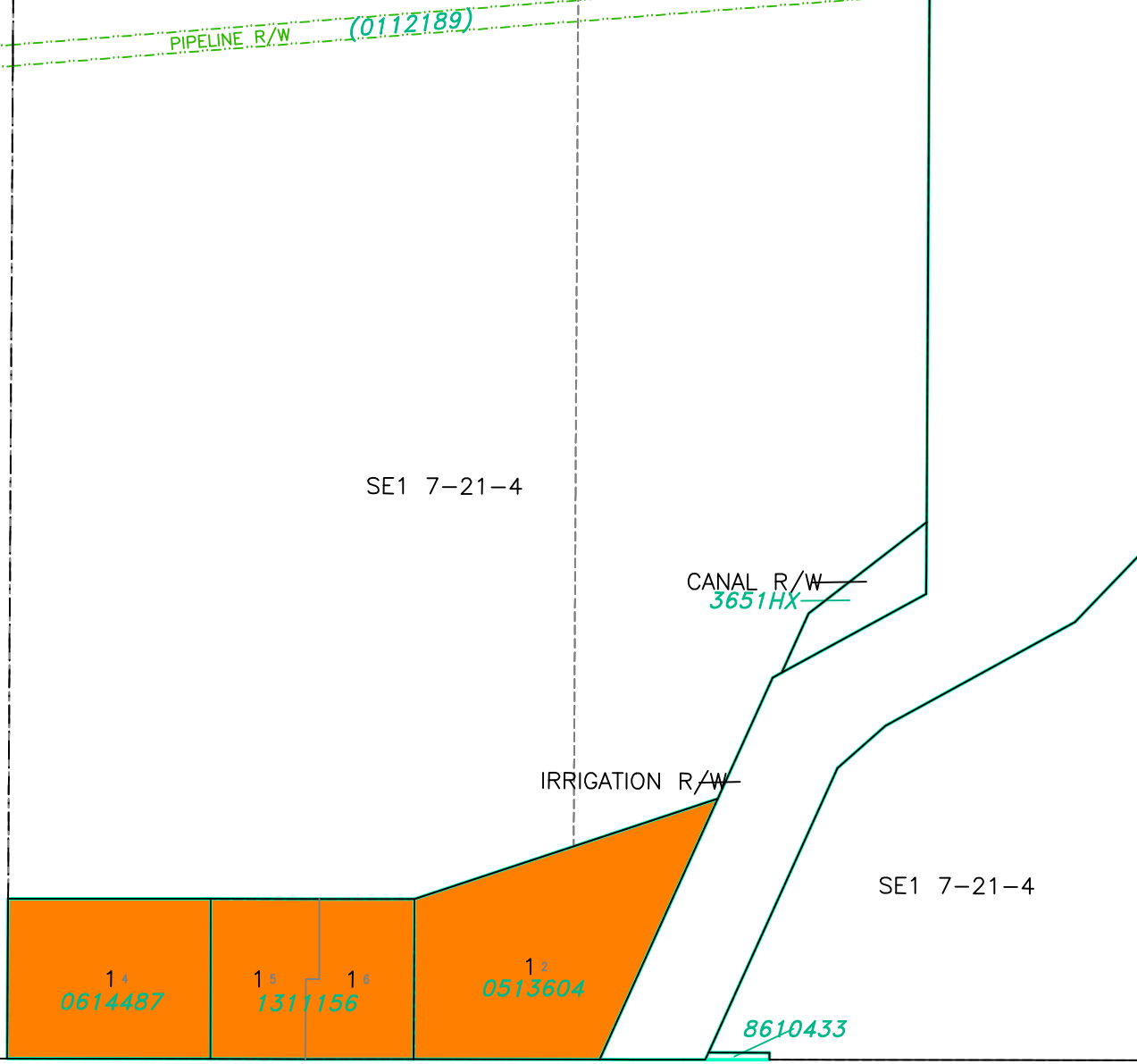

-  GROUPED COUNTY RESIDENTIAL (GCR)
-  EXTENSIVE AGRICULTURE (AG)



COUNTY OF WARNER NO. 5  
LAND USE DISTRICTS  
MAP 2

PORTION OF  
SW 1/4 SEC 36, TWP 6, RGE 21, W4M  
& Lots 1, 2 & 3, Block 2, Plan 0712599

LAND USE DISTRICTS  
Bylaw No: 930-17  
October 24, 2017

-  GROUPED COUNTY RESIDENTIAL (GCR)
-  EXTENSIVE AGRICULTURE (AG)

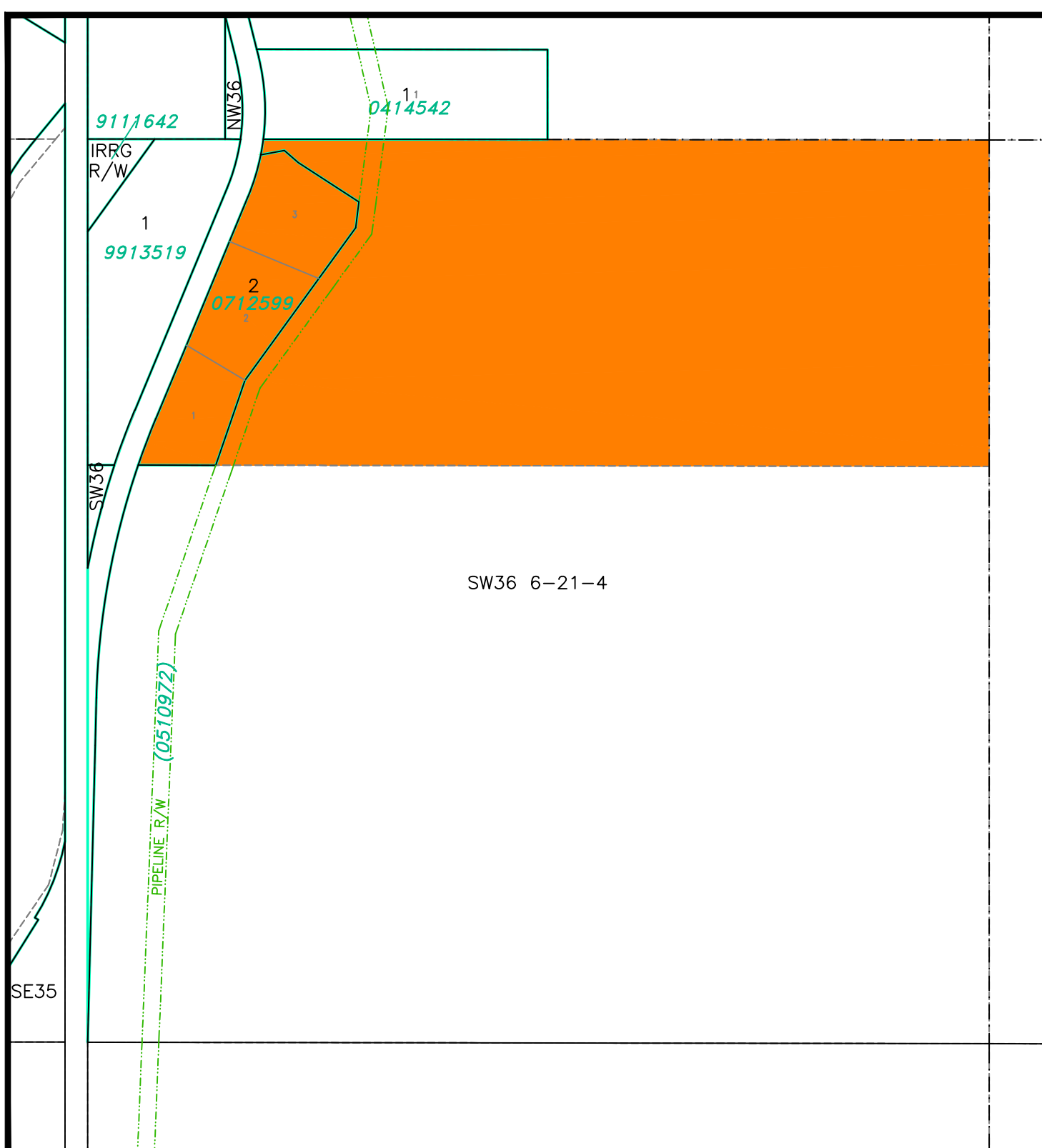



MAP PREPARED BY:  
OLDMAN RIVER REGIONAL SERVICES COMMISSION  
3105 10th AVENUE NORTH, LETHBRIDGE, ALBERTA, T1M 0G9  
TEL: 403-329-1344  
"NOT RESPONSIBLE FOR ERRORS OR OMISSIONS"



COUNTY OF WARNER NO. 5  
 LAND USE DISTRICTS  
 MAP 3

Lots 4 To 7, Block 4, Plan 0715123,  
 Lots 8 to 10, Block 4, Plan 0912838 and  
 Lot 69 and Portions of  
 Lots 68 & 70, Plan 1345J in  
 NW 1/4 SEC 11, TWP 6, RGE 21, W4M  
 Lots 1 to 5, Block 2, Plan 0811109 In  
 SW 1/4 SEC 14, TWP 6, RGE 21, W4M

LAND USE DISTRICTS  
 Bylaw No: 930-17  
 October 24, 2017

-  GROUPED COUNTY RESIDENTIAL (GCR)
-  EXTENSIVE AGRICULTURE (AG)

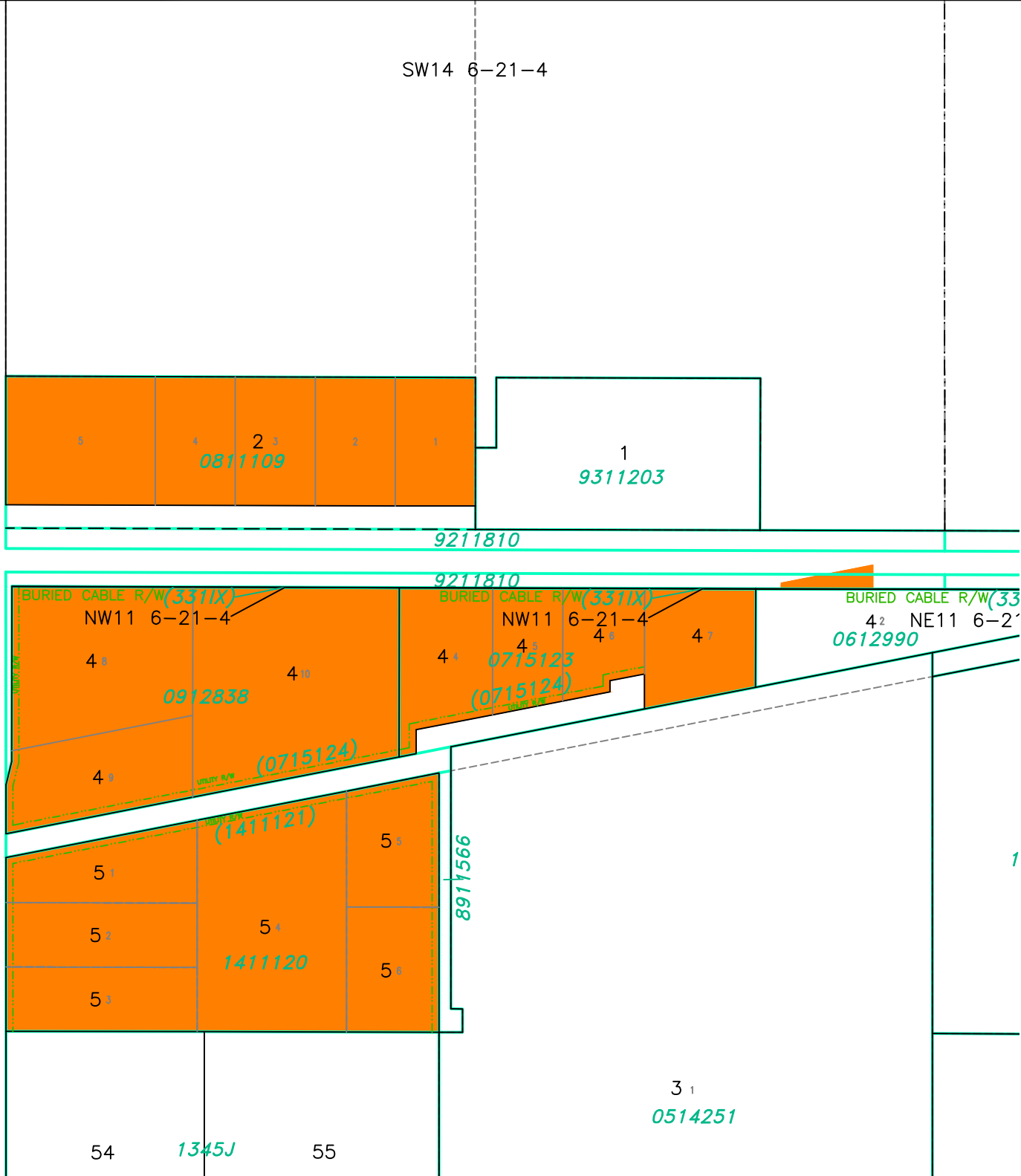

COUNTY OF WARNER NO. 5  
 LAND USE DISTRICTS  
 MAP 4

Block 1, Plan 9610970 &  
 Lots 1 to 5, Block 2, Plan 0714201 In  
 NE 1/4 SEC 27, TWP 5, RGE 20, W4M  
 & SE 1/4 SEC 27, TWP 5, RGE 20, W4M

LAND USE DISTRICTS  
 Bylaw No: 930-17  
 October 24, 2017  
 Amending Bylaw 940-18

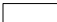
-  GROUPED COUNTY RESIDENTIAL (GCR)
-  EXTENSIVE AGRICULTURE (AG)

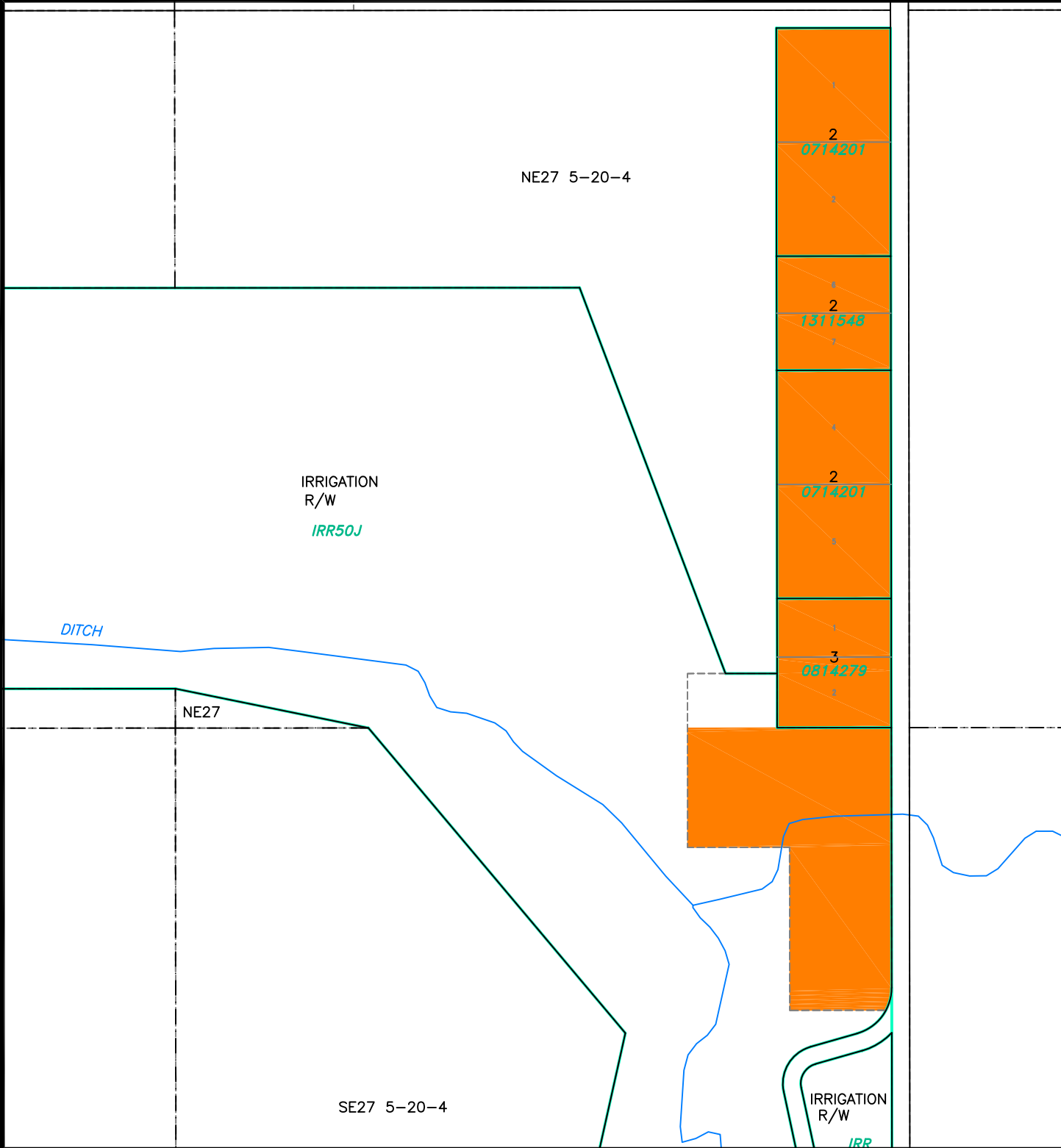

COUNTY OF WARNER NO. 5  
 LAND USE DISTRICTS  
 MAP 5

Lots 1 To 6, Block 1, Plan 0812901 &  
 Portion Of  
 SE 1/4 SEC 27, TWP 6, RGE 21, W4M

LAND USE DISTRICTS  
 Bylaw No: 930-17  
 October 24, 2017

- GROUPED COUNTY RESIDENTIAL (GCR)
- EXTENSIVE AGRICULTURE (AG)

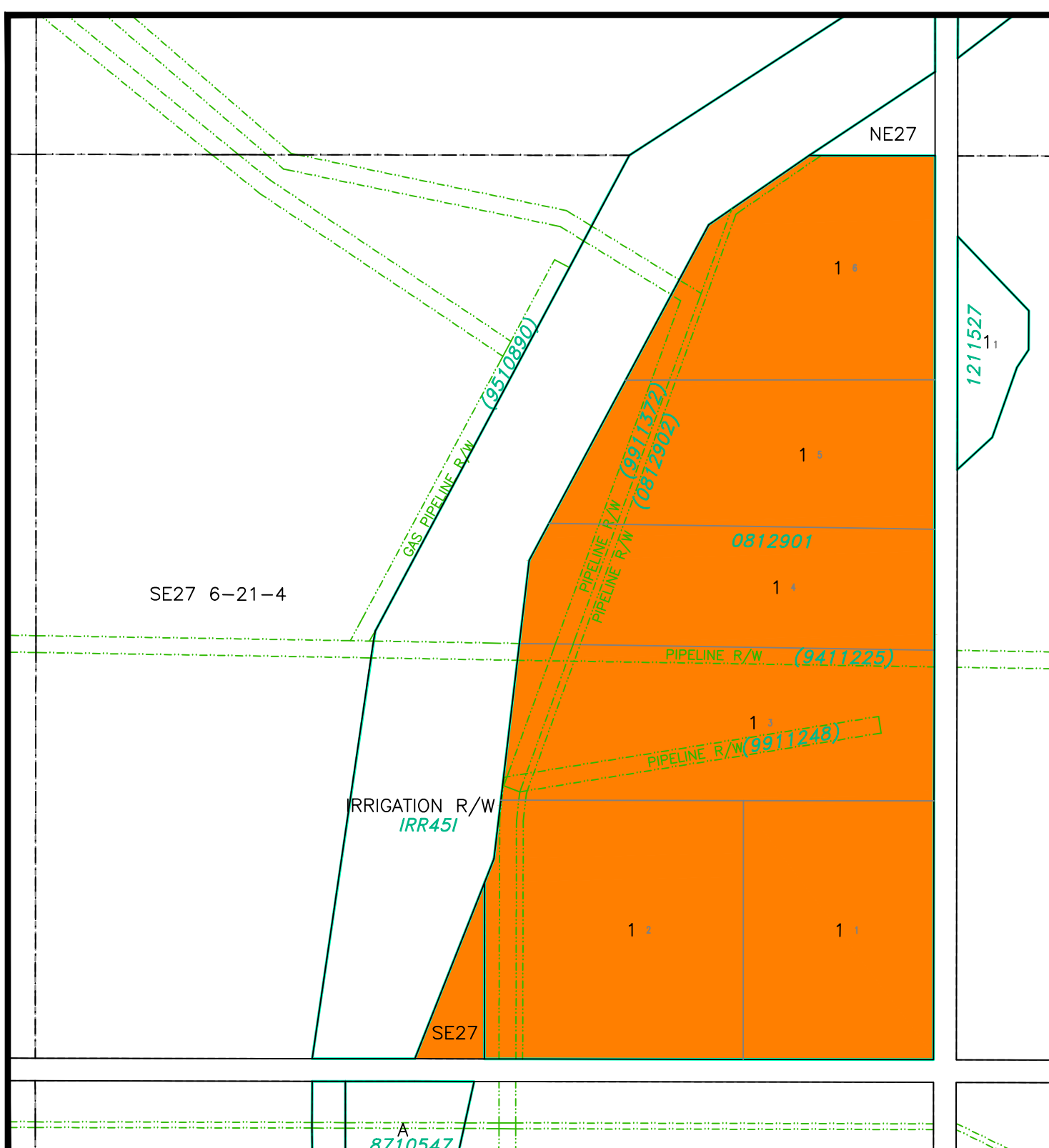

MAP PREPARED BY:  
 OLDMAN RIVER REGIONAL SERVICES COMMISSION  
 3105 10th AVENUE NORTH, LETHBRIDGE, ALBERTA T1V 2E9  
 TEL: 403-329-1344  
 \*NOT RESPONSIBLE FOR ERRORS OR OMISSIONS\*





COUNTY OF WARNER NO. 5  
 LAND USE DISTRICTS  
 MAP 6

PORTION OF  
 SW 1/4 SEC 14, TWP 6, RGE 20, W4M

SW14 6-20-4

CANAL R/W

SW14 6-20-4

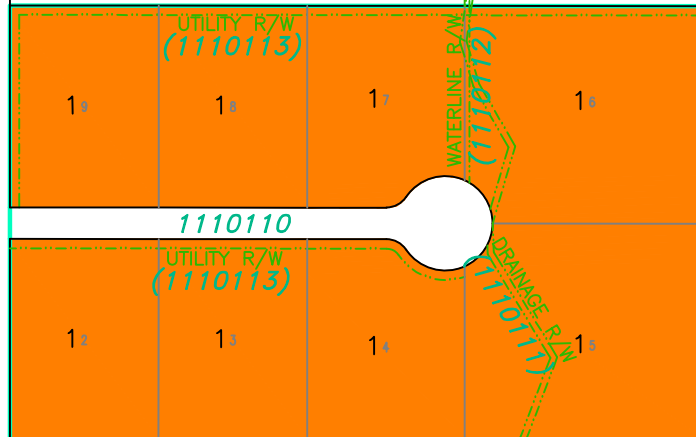

LAND USE DISTRICTS  
 Bylaw No: 930-17  
 October 24, 2017

- GROUPED COUNTY RESIDENTIAL (GCR)
- EXTENSIVE AGRICULTURE (AG)



5527HX

COUNTY OF WARNER NO. 5  
LAND USE DISTRICTS  
MAP 7

PORTION OF  
SE 1/4 SEC 3, TWP 7, RGE 20, W4M

SE3 7-20-4

LAND USE DISTRICTS  
Bylaw No: 930-17  
October 24, 2017

-  GROUPED COUNTY RESIDENTIAL (GCR)
-  EXTENSIVE AGRICULTURE (AG)

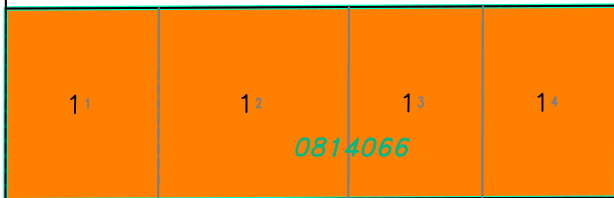

MAP PREPARED BY:  
OLDMAN RIVER REGIONAL SERVICES COMMISSION  
3105 10th AVENUE NORTH, LETHBRIDGE, ALBERTA T1M 0S2  
TEL: 403-329-1344  
"NOT RESPONSIBLE FOR ERRORS OR OMISSIONS"







November 08, 2017 \N\warn-county\warn-county\ud 8 Land Use\Risk\agator@warn-county\ud 8\0547 October 21 2017 8:00:00

COUNTY OF WARNER NO. 5  
 LAND USE DISTRICTS  
 MAP 8

Lots 2 To 6, Block 1, Plan 0511192 In  
 Portion Of SEC 5, TWP 7, RGE 19, W4M

LAND USE DISTRICTS  
 Bylaw No: 930-17  
 October 24, 2017

-  GROUPED COUNTY RESIDENTIAL (GCR)
-  EXTENSIVE AGRICULTURE (AG)
-  URBAN FRINGE (UF)
-  LINEAR PARCEL DIRECT CONTROL (LPDC)
-  URBAN FRINGE BOUNDARY

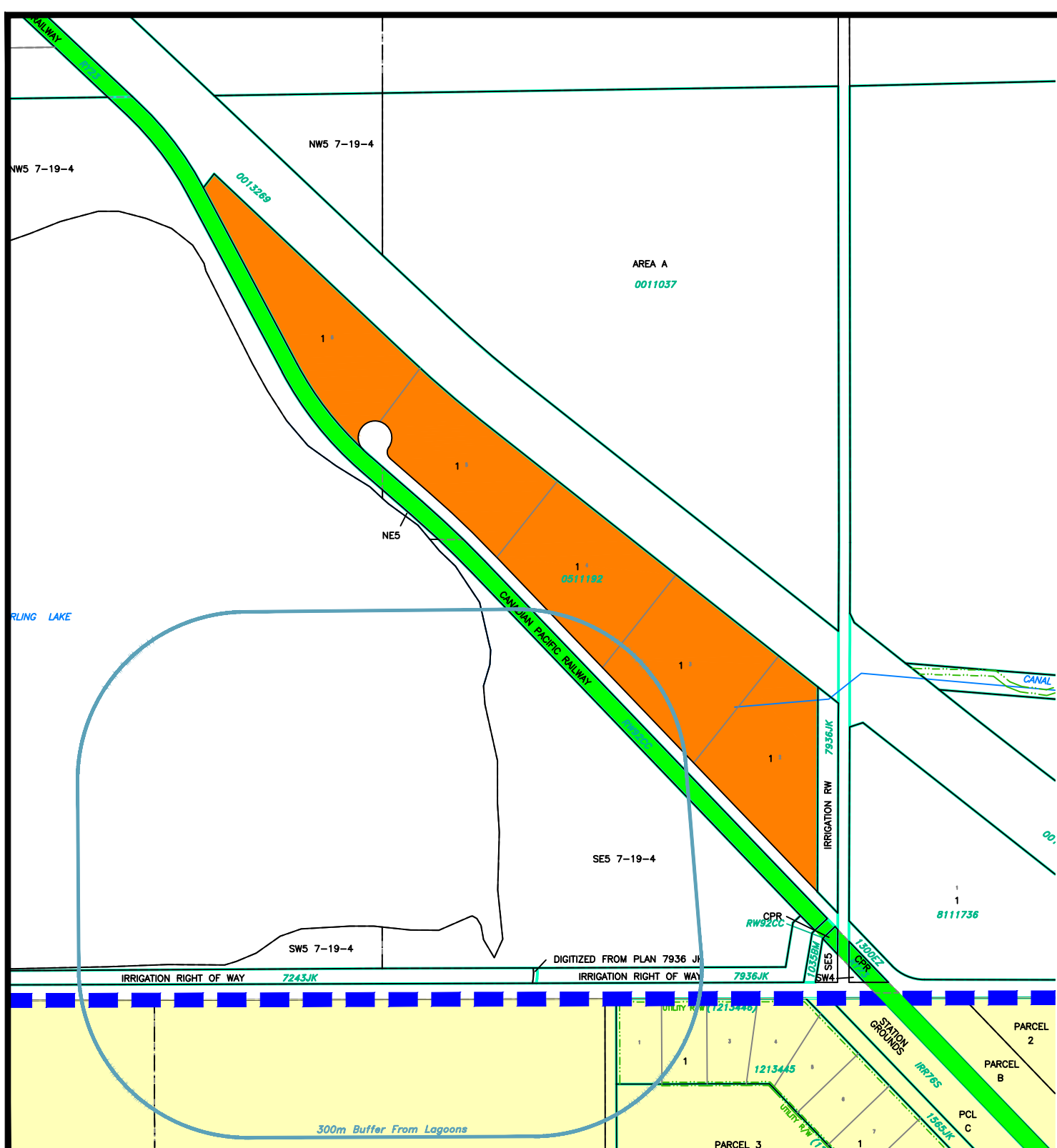



MAP PREPARED BY:  
 OLDMAN RIVER REGIONAL SERVICES COMMISSION  
 3105 10th AVENUE WEST/STY LEYBRIDGE, ALBERTA T4M 0S9  
 TEL: 403-329-1344  
 \*NOT RESPONSIBLE FOR ERRORS OR OMISSIONS\*





COUNTY OF WARNER NO. 5  
 LAND USE DISTRICTS  
 MAP 9

Portion Of  
 N 1/2 SEC 6, TWP 5, RGE 19, W4M

LAND USE DISTRICTS  
 Bylaw No: 930-17  
 October 24, 2017

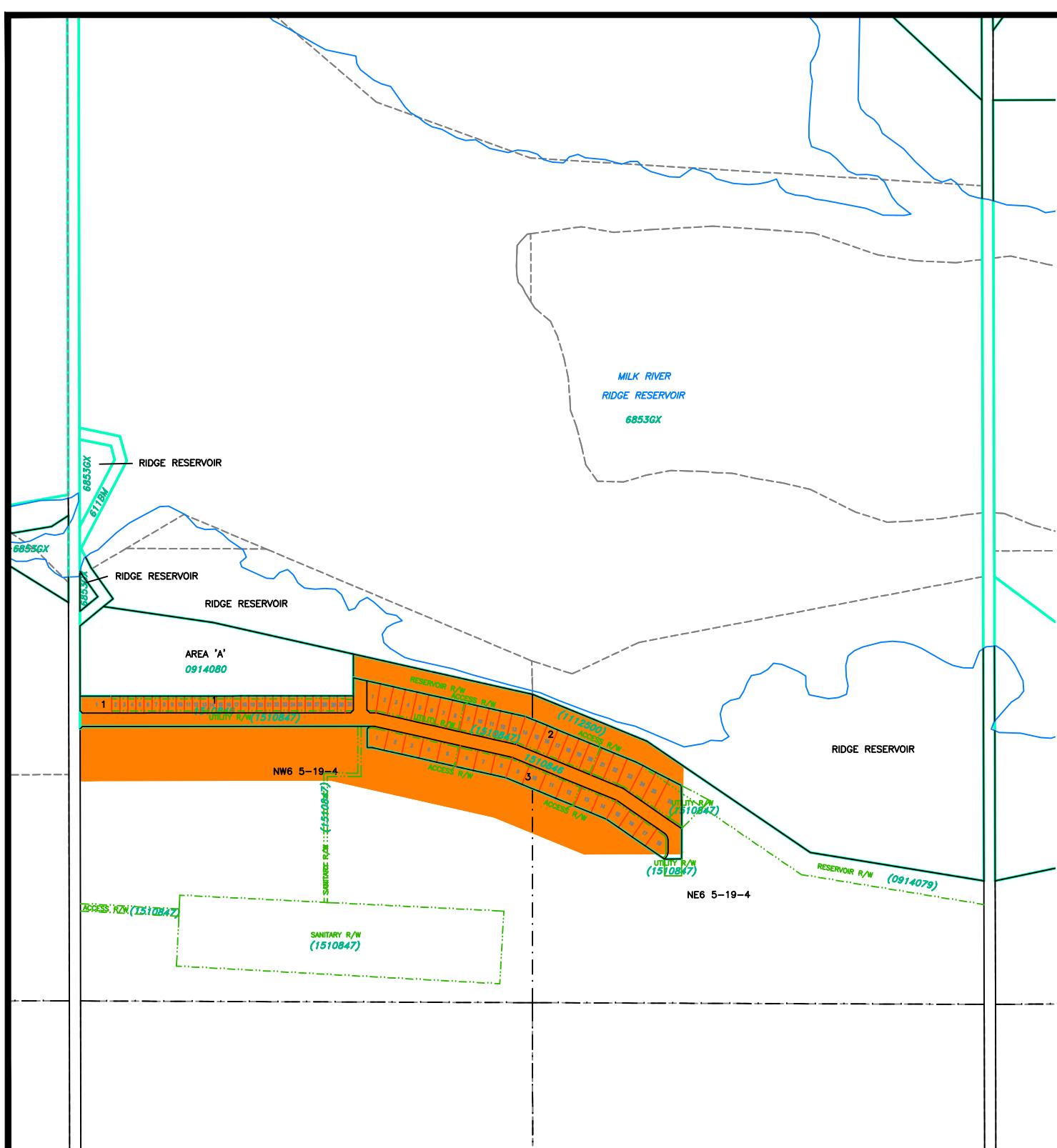

-  GROUPED COUNTY RESIDENTIAL (GCR)
-  EXTENSIVE AGRICULTURE (AG)



COUNTY OF WARNER NO. 5  
 LAND USE DISTRICTS  
 MAP 10

Portions Of  
 LSD's 13, 14, 15 & 16 in the  
 NE & NW SEC 25, TWP 7, RGE 17, W 4 M  
 & LSD's 3, 4 & 5 in the  
 SW SEC 36, TWP 7, RGE 17, W 4 M

LAND USE DISTRICTS  
 Bylaw No: 930-17  
 October 24, 2017

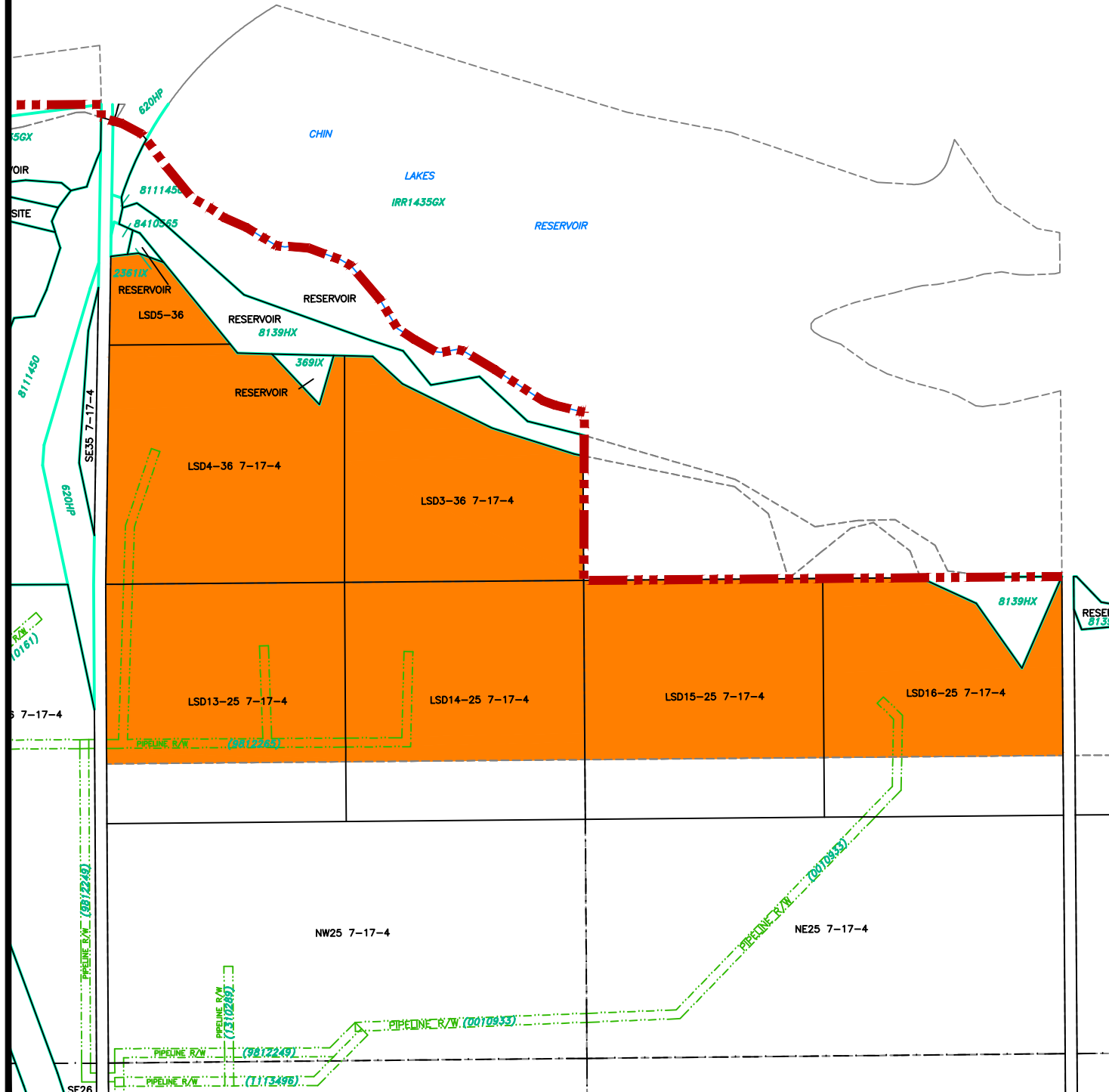

-  GROUPED COUNTY RESIDENTIAL (GCR)
-  EXTENSIVE AGRICULTURE (AG)



COUNTY OF WARNER NO. 5  
LAND USE DISTRICTS  
MAP 11

Portion Of  
SE 1/4 SEC 17, TWP 5, RGE 20, W4M

LAND USE DISTRICTS  
Bylaw No: 930-17  
October 24, 2017

-  GROUPED COUNTY RESIDENTIAL (GCR)
-  EXTENSIVE AGRICULTURE (AG)

RESERVOIR

SE17 5-20-4

RESERVOIR

3549AZ  
6853GX

RIVER RIDGE RESERVOIR  
6853GX

RESERVOIR  
6853GX

1510635



3549AZ

3549AZ  
NE8

COUNTY OF WARNER NO. 5  
LAND USE DISTRICTS  
MAP 12

Portion Of  
SE 1/4 SEC 6, TWP 7, RGE 20, W4M

LAND USE DISTRICTS  
Bylaw No: 930-17  
October 24, 2017

-  GROUPED COUNTY RESIDENTIAL (GCR)
-  EXTENSIVE AGRICULTURE (AG)

3 4  
1412011

3 2  
1312908

1212613

8710453

SE6 7-20-4

1  
9610

SE6 7-20-4

1



1

1

COUNTY OF WARNER NO. 5  
LAND USE DISTRICTS  
MAP 13

Lots 4 & 5, Block 1, Plan 9711687 &  
Lot 61, Plan 1345J in  
NE 1/4 SEC 11, TWP 6, RGE 21, W 4 M

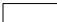
LAND USE DISTRICTS  
Bylaw No: 930-17  
October 24, 2017

-  GROUPED COUNTY RESIDENTIAL (GCR)
-  EXTENSIVE AGRICULTURE (AG)
-  URBAN FRINGE (UF)

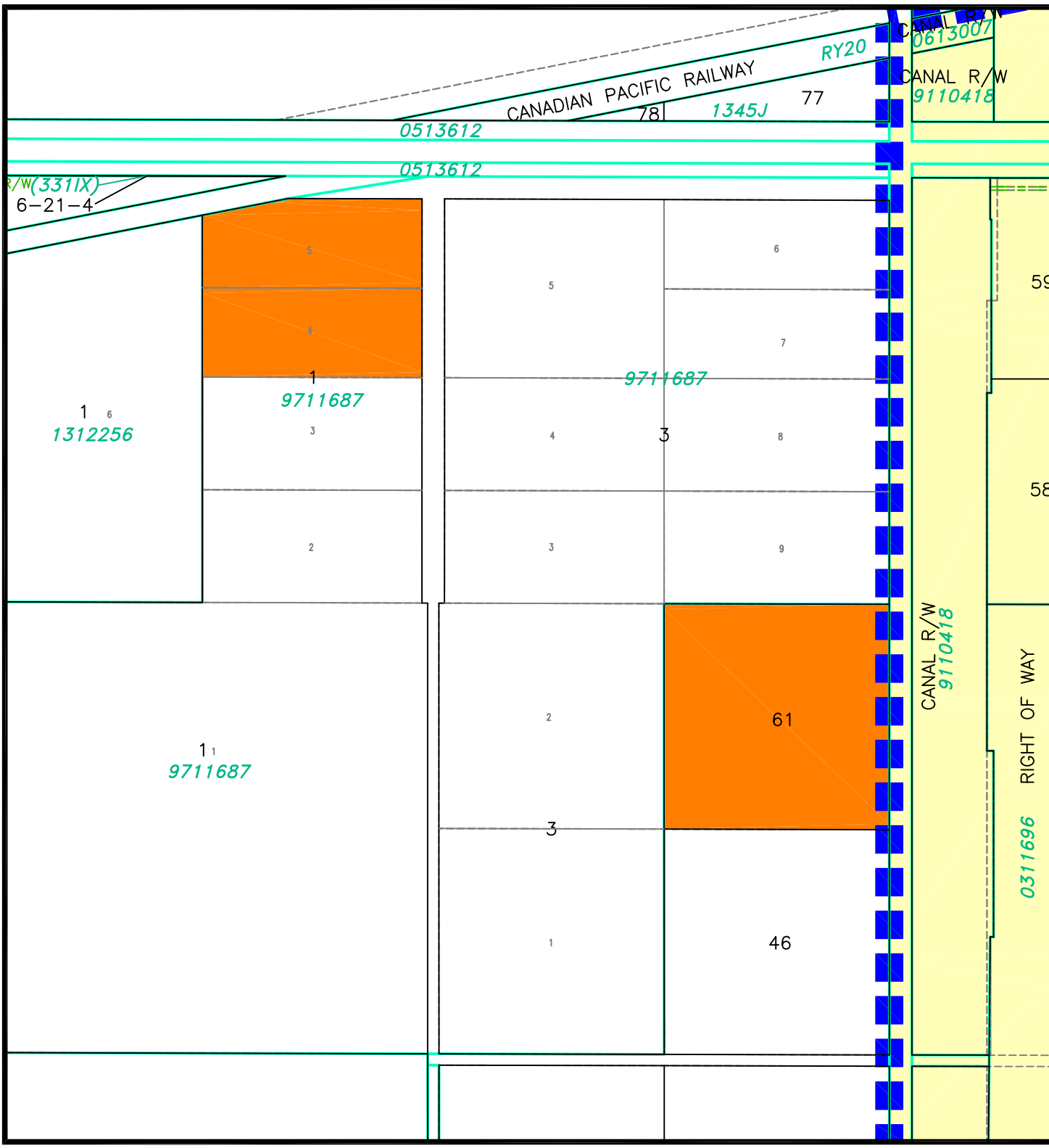



COUNTY OF WARNER NO. 5  
 LAND USE DISTRICTS  
 MAP 14

Portion Of  
 NW 1/4 SEC 13, TWP 5, RGE 20, W 4 M

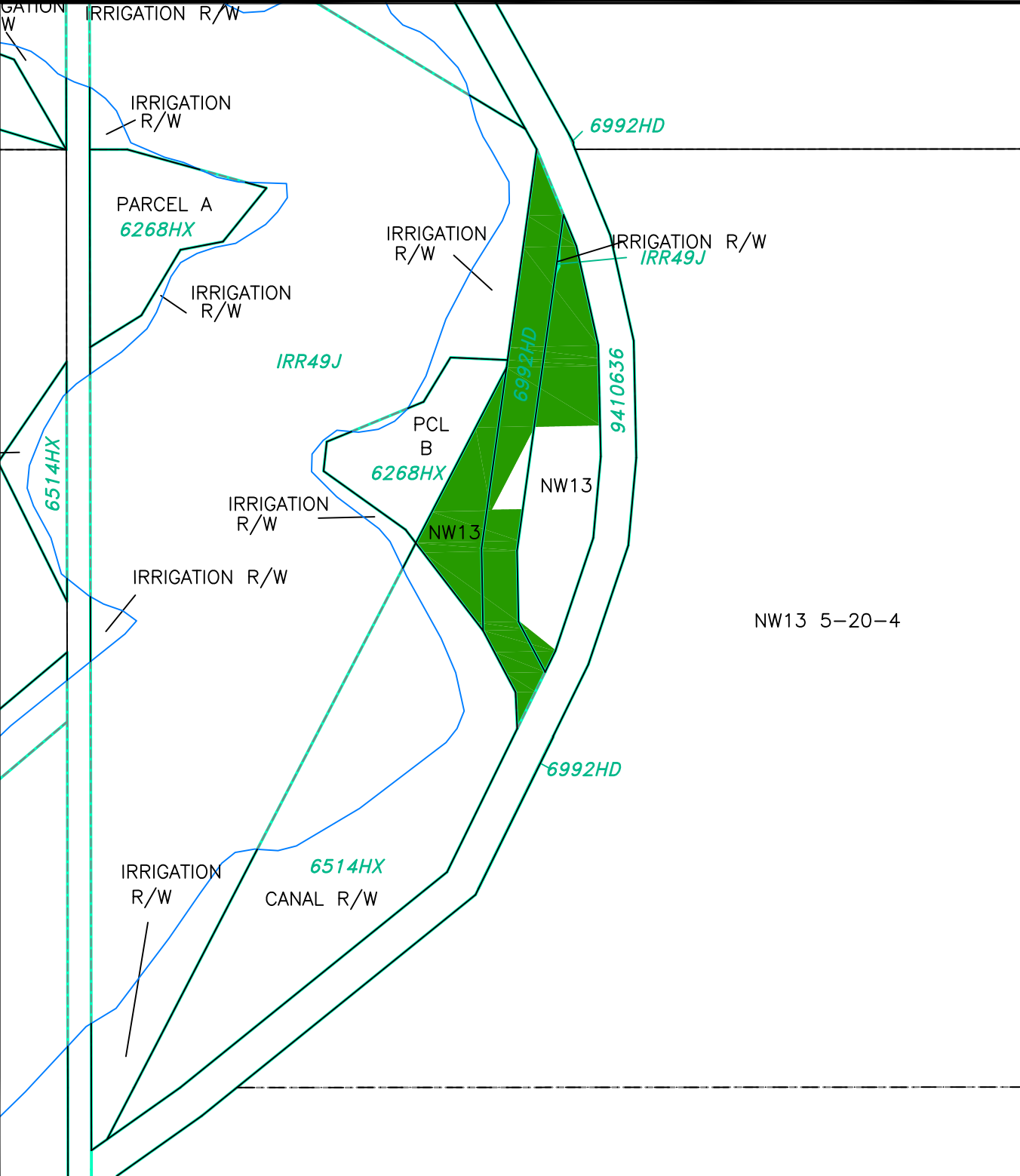

NW13 5-20-4

- LAND USE DISTRICTS
- Bylaw No: 930-17
  - October 24, 2017
  - Amending Bylaw 933-18
  - RURAL RECREATIONAL (RR)
  - EXTENSIVE AGRICULTURE (AG)

COUNTY OF WARNER NO. 5  
LAND USE DISTRICTS  
MAP 15

Lot 1, Block 2, Plan 0110579 within  
SE 1/4 SEC 29, TWP 6, RGE 20, W4M

SE29 6-20-4

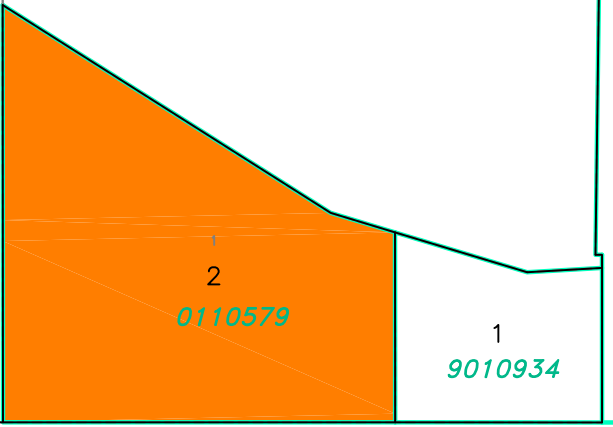

LAND USE DISTRICTS  
Bylaw No: 930-17  
October 24, 2017  
Amending Bylaw 988-23

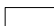
-  GROUPED COUNTY RESIDENTIAL (GCR)
-  EXTENSIVE AGRICULTURE (AG)